

Series 4030 End Suction Base Mounted

3 x 2 x 10

SUBMITTAL

| | |
|-------------------|---------------------------------|
| JOB: _____ | REPRESENTATIVE: _____ |
| ENGINEER: _____ | ORDER NO: _____ DATE: _____ |
| CONTRACTOR: _____ | SUBMITTED BY: _____ DATE: _____ |
| | APPROVED BY: _____ DATE: _____ |

| PUMP DESIGN DATA | |
|-----------------------------------|-------------------------------|
| NO. OF PUMPS: | TAG: |
| CAPACITY: m ³ /h (L/s) | HEAD: m (ft) |
| LIQUID: | VISCOSITY: |
| TEMPERATURE: °C (°F) | SPECIFIC GRAVITY: |
| SUCTION: 75 mm (3") Flanged** | DISCHARGE: 50 mm (2") Flanged |

| MOTOR DESIGN DATA | |
|--|---------------------------------------|
| HP: | RPM: |
| FRAME SIZE: | ENCLOSURE: |
| VOLTS: | HERTZ: 50 Hz |
| EFFICIENCY*: <input type="checkbox"/> NEMA Premium (12.12) | <input type="checkbox"/> Other _____% |

*Fractional power & Frame 56 motors are supplied with the standard efficiency of the manufacturer.

| MATERIALS OF CONSTRUCTION | | | | |
|---------------------------------------|--------------------------------------|-----------------------------|--------------------------------------|-----------------------------|
| ANSI FLANGE RATING | <input type="checkbox"/> ANSI 125 | | <input type="checkbox"/> ANSI 250 | |
| CONSTRUCTION | <input type="checkbox"/> BF | <input type="checkbox"/> AI | <input type="checkbox"/> BF | <input type="checkbox"/> AI |
| IMPELLER | BRONZE | CAST IRON | BRONZE | CAST IRON |
| CASING | CAST IRON | | DUCTILE IRON | |
| GASKET | CONFINED NON-ASBESTOS FIBER | | | |
| BEARING FRAME | CAST IRON | | | |
| ANTI-FRICTION BEARINGS | PERMANENTLY LUBRICATED | | | |
| SHAFT | CARBON STEEL | | | |
| SHAFT SLEEVE | STAINLESS STEEL | | | |
| COUPLER | WOODS SURE FLEX OR EQUAL | | | |
| COUPLER GUARD | STEEL OSHA | | | |
| BASEPLATE | FABRICATED STEEL | | | |
| MAX. PUMP OPERATING CONDITIONS | 12 bars at 66°C (175 psig at 150°F) | | 20 bars at 65°C (300 psig at 150°F) | |
| | 10 bars at 121°C (140 psig at 250°F) | | 14 bars at 121°C (210 psig at 250°F) | |

- TOLERANCE OF ±3 mm (±0.125") SHOULD BE USED
- FOR EXACT INSTALLATION DATA PLEASE WRITE FACTORY FOR CERTIFIED DIMENSIONS
- SEE PERFORMANCE CURVES ON PAGE 2
- PUMP EQUIPPED WITH CASING DRAIN PLUG AND 1/4" NPT SUCTION AND DISCHARGE GAUGE PORTS

| MECHANICAL SEAL DESIGN DATA | | |
|-----------------------------|------------------------|--------------------------|
| FLUID TYPE | NON-POTABLE | POTABLE (DRINKING) WATER |
| SEAL TYPE | 2A | |
| ROTATING FACE | ANTIMONY LOADED CARBON | RESIN BONDED CARBON |
| STATIONARY SEAT | SILICON CARBIDE | |
| SECONDARY SEAL | VITON | EPDM |
| SPRING | STAINLESS STEEL | |
| ROTATING HARDWARE | STAINLESS STEEL | |

OPTIONAL EQUIPMENT

FOR PERFORMANCE CURVES SEE PAGE 2

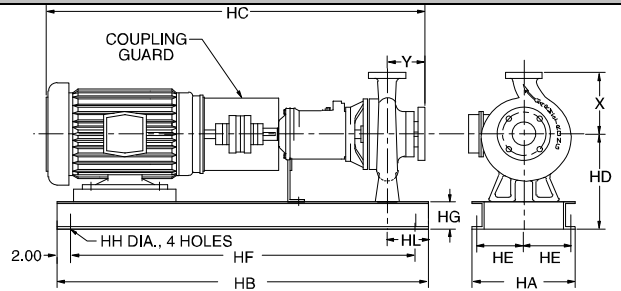

| MOTOR HORSEPOWER | | | | | MAX. DIMENSIONS mm (inches) | | | | | | | | | | | MAX. ASSEMBLY WEIGHT* |
|------------------|------|------|------|-------|-----------------------------|--------------|--------------|-------------|------------|--------------|------------|-----------|------------|------------|------------|-----------------------|
| ODP | | TEFC | | FRAME | ODP / TEFC | | | | | | | | | | | kg (lbs.) |
| 3000 | 1500 | 3000 | 1500 | | HA | HB | HC | HD | HE | HF | HG | HH | HL | X | Y | |
| --- | 2 | --- | 2 | 145T | 356 (14.00) | 762 (30.00) | 701 (27.61) | 286 (11.25) | 162 (6.38) | 660 (26.00) | 76 (3.00) | 19 (0.75) | 114 (4.50) | 241 (9.50) | 102 (4.00) | 81.7 (180) |
| --- | 3 | --- | 3 | 182T | 356 (14.00) | 762 (30.00) | 770 (30.31) | 286 (11.25) | 162 (6.38) | 660 (26.00) | 76 (3.00) | 19 (0.75) | 114 (4.50) | 241 (9.50) | 102 (4.00) | 93.1 (205) |
| --- | 5 | --- | 5 | 184T | 356 (14.00) | 762 (30.00) | 770 (30.31) | 286 (11.25) | 162 (6.38) | 660 (26.00) | 76 (3.00) | 19 (0.75) | 114 (4.50) | 241 (9.50) | 102 (4.00) | 97.6 (215) |
| --- | 7.5 | --- | 7.5 | 213T | 356 (14.00) | 838 (33.00) | 863 (33.98) | 286 (11.25) | 162 (6.38) | 737 (29.00) | 76 (3.00) | 19 (0.75) | 114 (4.50) | 241 (9.50) | 102 (4.00) | 113.5 (250) |
| 15 | --- | --- | --- | 215T | 356 (14.00) | 838 (33.00) | 863 (33.98) | 286 (11.25) | 162 (6.38) | 737 (29.00) | 76 (3.00) | 19 (0.75) | 114 (4.50) | 241 (9.50) | 102 (4.00) | 111.2 (245) |
| 20 | --- | 15 | --- | 254T | 406 (16.00) | 1143 (45.00) | 1107 (43.59) | 286 (11.25) | 187 (7.38) | 1041 (41.00) | 76 (3.00) | 19 (0.75) | 114 (4.50) | 241 (9.50) | 102 (4.00) | 174.8 (385) |
| 25 | --- | 20 | --- | 256T | 406 (16.00) | 1143 (45.00) | 1107 (43.59) | 286 (11.25) | 187 (7.38) | 1041 (41.00) | 76 (3.00) | 19 (0.75) | 114 (4.50) | 241 (9.50) | 102 (4.00) | 183.9 (405) |
| 30 | --- | 25 | --- | 284TS | 483 (19.00) | 1219 (48.00) | 1145 (45.09) | 311 (12.25) | 225 (8.88) | 1118 (44.00) | 102 (4.00) | 19 (0.75) | 114 (4.50) | 241 (9.50) | 102 (4.00) | 193.0 (425) |
| 40 | --- | 30 | --- | 286TS | 483 (19.00) | 1219 (48.00) | 1145 (45.09) | 311 (12.25) | 225 (8.88) | 1118 (44.00) | 102 (4.00) | 19 (0.75) | 114 (4.50) | 241 (9.50) | 102 (4.00) | 224.7 (495) |
| 50 | --- | 40 | --- | 324TS | 483 (19.00) | 1219 (48.00) | 1219 (48.01) | 311 (12.25) | 225 (8.88) | 1118 (44.00) | 102 (4.00) | 19 (0.75) | 114 (4.50) | 241 (9.50) | 102 (4.00) | 329.2 (725) |
| --- | --- | 50 | --- | 326TS | 483 (19.00) | 1219 (48.00) | 1219 (48.01) | 311 (12.25) | 225 (8.88) | 1118 (44.00) | 102 (4.00) | 19 (0.75) | 114 (4.50) | 241 (9.50) | 102 (4.00) | 372.3 (820) |

*Assembly weight combines pump and motor.



PERFORMANCE CURVES

Performance Guaranteed Only At Operating Point Indicated

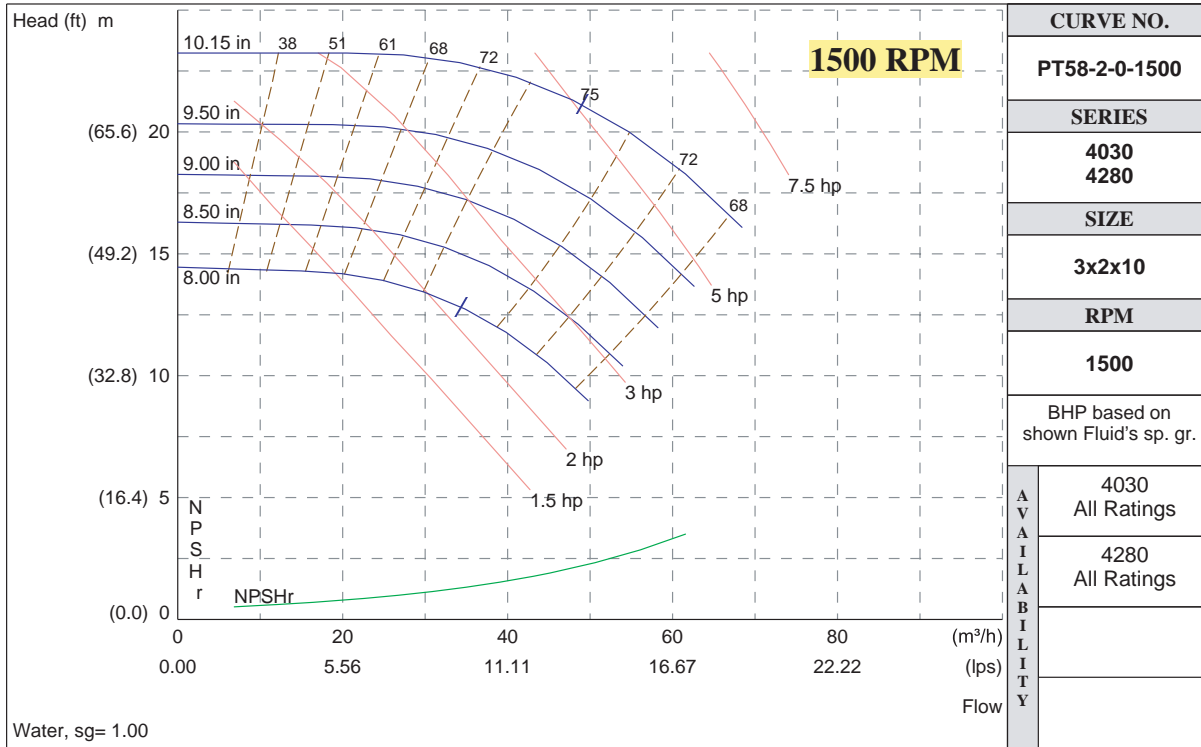
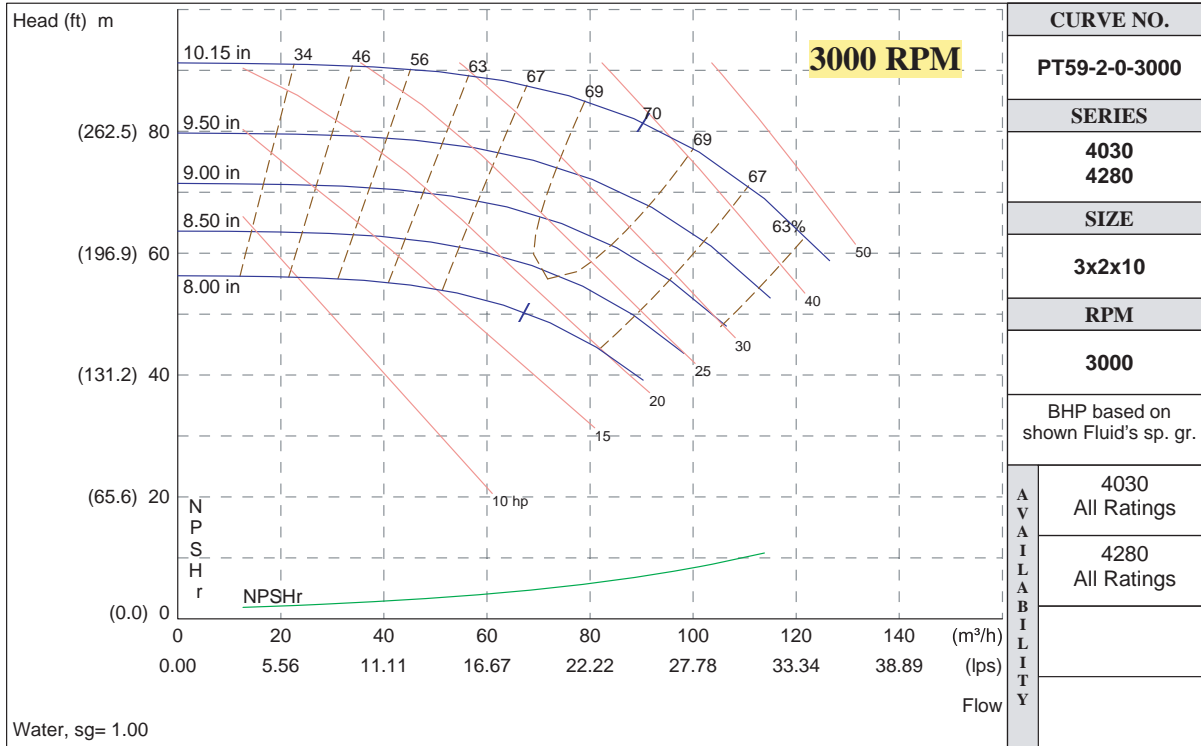

Armstrong Integrated Limited
 Wenlock Way
 Manchester
 United Kingdom, M12 5JL
 T: +44 (0) 8444 145 145
 F: +44 (0) 8444 145 146

S. A. Armstrong Limited
 23 Bertrand Avenue
 Toronto, Ontario
 Canada, M1L 2P3
 T: 416-755-2291
 F: 416-759-9101



© S.A. Armstrong Limited 2011